

#14

951

NAVARRO COUNTY COMMISSIONERS COURT
ORDER NO. 103-2020

On the 22nd day of June 2020, the County Commissioners Court of Navarro County, Texas, convened in Special Session of the said Court, at 300 West 3rd Ave., Corsicana, Navarro County, Texas, with the following members present, to wit:

County Judge	H. M. Davenport, Jr.
Commissioner, Precinct 1	Jason Grant
Commissioner, Precinct 2	Eddie Perry
Commissioner, Precinct 3	Eddie Moore
Commissioner, Precinct 4	James Olsen

and among other proceedings, on Motion of Commissioner Moore, seconded by Commissioner Perry, being duly put and carried, the following Order was passed.

WHEREAS, Chapter 251 of the Texas Transportation Code authorizes the County Commissioners Court to close, abandon, and vacate certain identified county roads or portions of roads; and

WHEREAS, on June 22, 2020, the Navarro County Commissioners Court has closed upon request S.W.C.R. 0080-said road as being the same as in the attached Exhibit "A" approximately 960 feet owned by Ken & Paula Cook on both sides of the road. This road is to be closed, abandoned, and vacated pursuant to the terms of Chapter 251 of the Texas Transportation Code:

Now therefore, BE IT ORDERED by the Commissioners Court of Navarro County, Texas, which S.W.C.R. 0080 or more specifically, portions of said road as noted above, is hereby **CLOSED, ABANDONED, AND VACATED**.

BE IT FURTHER ORDERED that this Clarification Order is officially filed with the Navarro County Clerk, as is required by law.

APPROVED by the Navarro County Commissioners Court on this 22nd day of June, 2020.



Honorable H.M. Davenport, Jr.
Navarro County Judge



Jason Grant
Commissioner, Precinct 1



Eddie Perry
Commissioner, Precinct 2

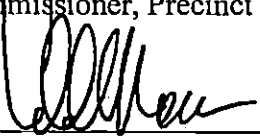

Eddie Moore
Commissioner, Precinct 3

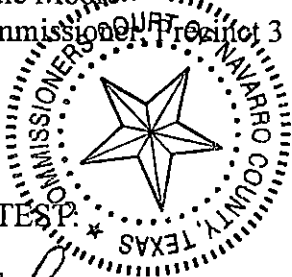
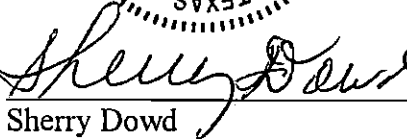

James Olsen
Commissioner, Precinct 4

ATTEST

Sherry Dowd
Navarro County Clerk



953

6/19/2020, 11:39:59 AM

Parcels
 Abstracts
 Lot Lines

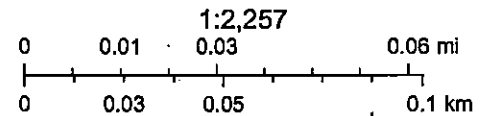

© OpenStreetMap (and) contributors, CC-BY-SA

Navarro County Appraisal District, BIS Consulting - www.bisconsulting.com

Disclaimer: This product is for informational purposes only and has not been prepared for or be suitable for legal, engineering, or surveying purposes. It does not represent an on-the-ground survey and represents only the approximate relative location of boundaries.

Navarro CAD Web Map

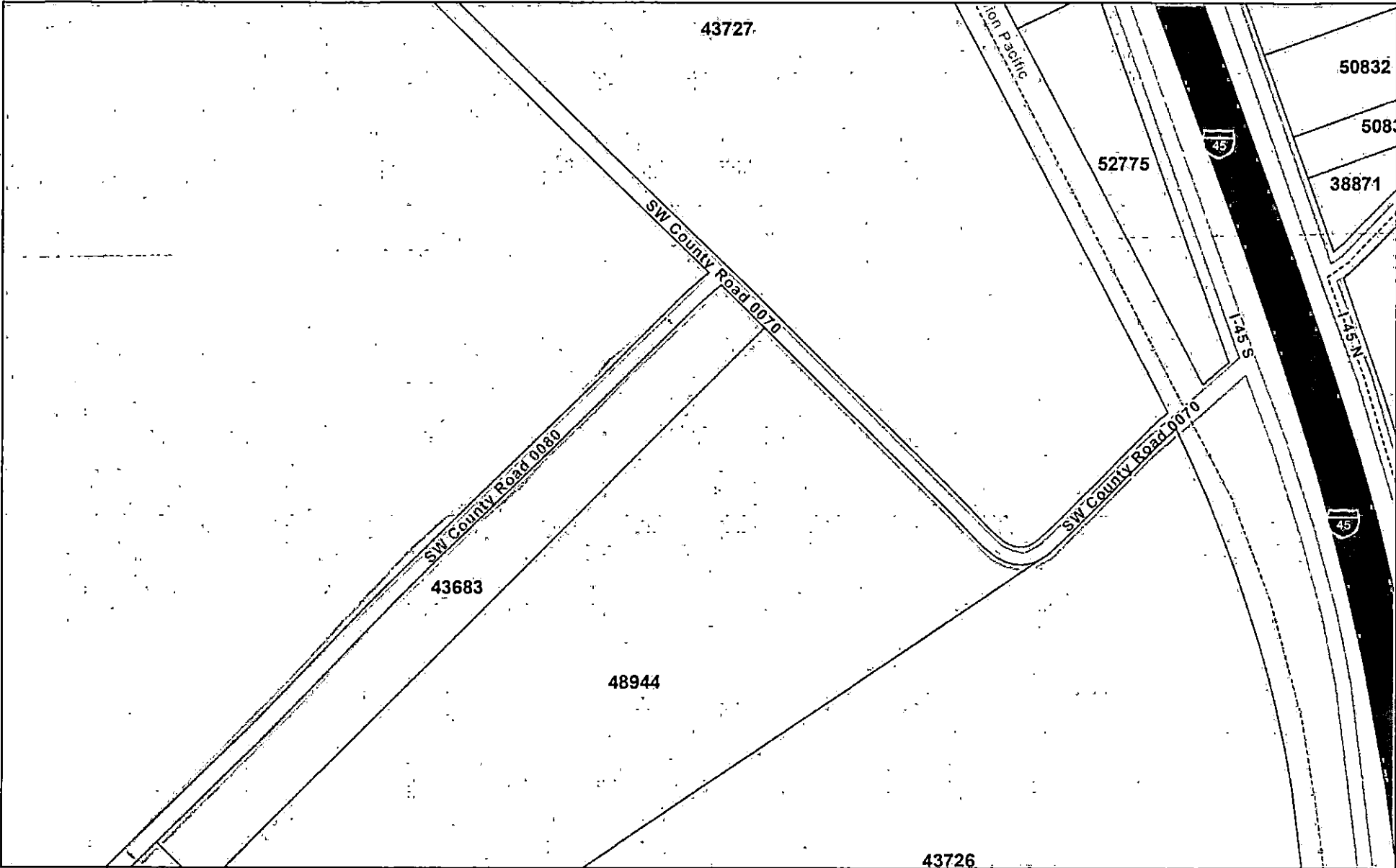

6/19/2020, 1:31:46 PM

- Parcels
- Abstracts

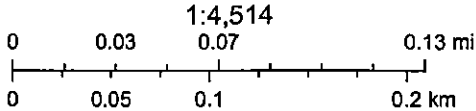

Sources: Esri, HERE, Garmin, FAO, NOAA, USGS, © OpenStreetMap contributors, and the GIS User Community

Navarro County Appraisal District, BIS Consulting - www.bisconsulting.com

Disclaimer: This product is for informational purposes only and has not been prepared for or be suitable for legal, engineering, or surveying purposes. It does not represent an on-the-ground survey and represents only the approximate relative location of boundaries.